

Centre Square Buildings

BUILDING NO 3 CENTRE SQUARE

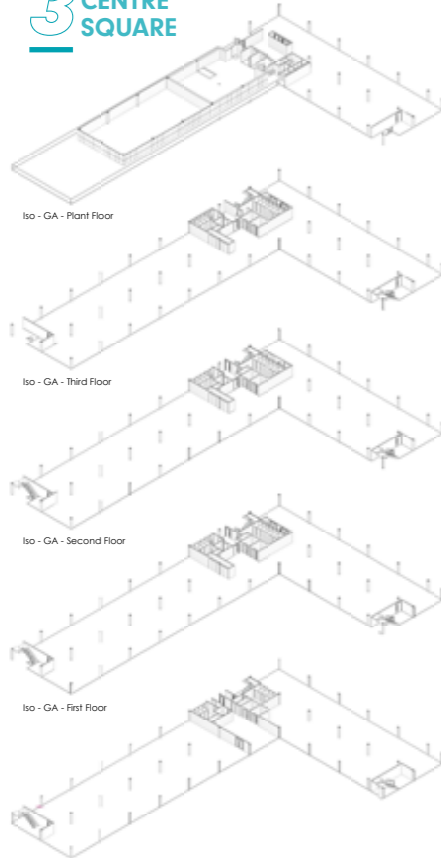

DESCRIPTION

With a similar plan form to Two Centre Square, one wing of the 52,365 sq ft (NIA) building closes the vista across Centre Square from Albert Road and consequently is highly visible from one of the main north-south routes through the town. The 'L' shape encloses two sides of the new civic square. Overlooking Centre Square, the west wing is five storeys tall while the adjacent wing is four storeys. The latter also enjoys views across the new square, while the top floors have a panoramic view to the south and the Hambleton Hills. A combination of curtain wall and iridescent cladding panels sit within a strong white brick frame.

SPECIFICATION HIGHLIGHTS

- Four and five storeys respectively
- 52,365 sq ft Net Internal Area (NIA)
- 7.5m structural grid to minimise the number of internal columns
- 5,809 sq ft A3 floor space
- 108 car parking spaces
- 2 eco-efficient passenger lifts
- VRF comfort cooling with heat recovery
- 3m clear ceiling height
- 150mm raised access floor void for power & data
- Suspended ceiling with semi-recessed LG7, LED fittings
- Solar water heating system
- Roof mounted photo voltaic arrays to generate on-site electricity
- Rainwater harvesting system for WC and urinal flushing to reduce water consumption
- Mechanical ventilation with heat recovery
- Reduced energy consumption via solar shading
- Building energy management system
- A EPC Rating
- Excellent BREEAM New Construction 2014 rating

GROUND FLOOR

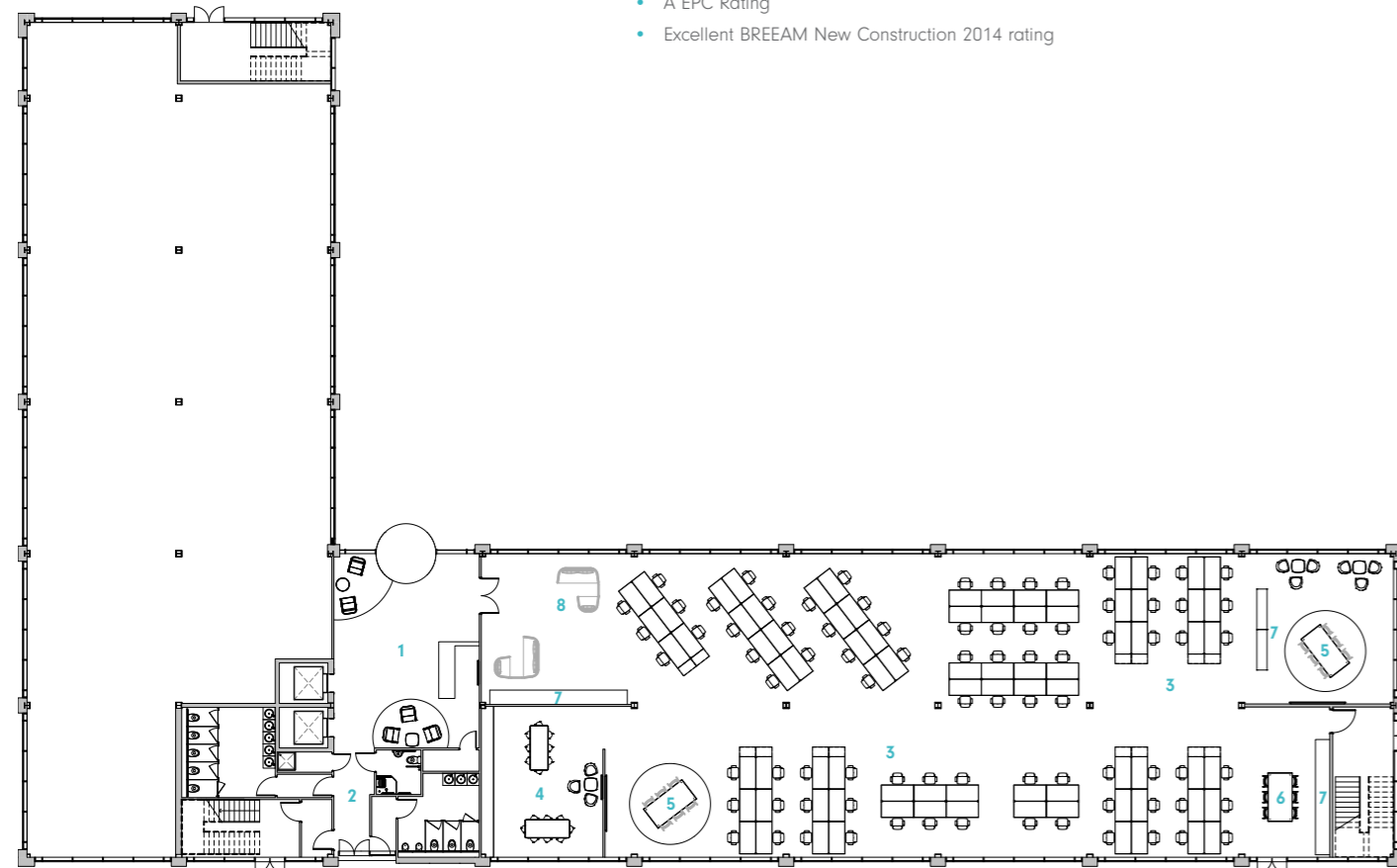

FIRST FLOOR



FLOORPLAN LEGEND

1. Reception
2. Central Core
3. Open Plan Desk (1:8m² excl. Breakout Seating)
4. Kitchenette / Staff Breakout
5. Interactive Breakout
6. Team / Project Breakout
7. Storage
8. Semi-private Meeting Pods
9. Private Meeting Rooms